





30 Donohue Street Kings Park NSW

3  3  1 

This superb family home has been expertly renovated with an open floor plan that will defiantly suit a modern family. Beautifully presented and featuring 3 generous bedrooms plus a separate study room.

The layout of the home is a stroke of genius with the second and third bedrooms both offering walk/in robes large enough to also be dressing rooms. The master bedroom also offers another walk/in robe plus an ultra-modern ensuite. The gourmet kitchen boasting dishwasher, gas cooking and plenty of storage is centrally located and surrounded by the large open living areas. You will also be impressed by the large covered entertaining area adjoining and flowing directly out through double sliding doors which in turn overlooks the sparkling inground pool.

Price : \$ 865,300
Land Size : 557.9 sqm
View : <https://www.elderskingslanglely.com.au/sale/nsw/western-sydney/kings-park/residential/house/5866279>



Charlotte Keene
02 9838 4888

30 Donohue Street,
Kings Park.

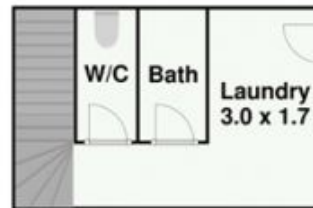

Sub Floor

Ground Floor



Plans are for presentation purposes only and are not part of any legal document or title. They should not be used as sole reference. Interested parties should make their own enquiries using other sources. Measurements are approximates.