



5 Wellesley Crescent Kings Park NSW

3  1 

Perfect for the first home buyer to start their family or the astute investor looking to grow their portfolio. This high side property is situated conveniently in the ever-popular Kings Langley Primary School zone, close to transport and also only minutes' drive to M7 & M2 motorways.

Price : \$ 717,000
Land Size : 559 sqm
View : <https://www.elderskingslangley.com.au/sale/nsw/western-sydney/kings-park/residential/house/5866851>

Positioned in a quiet street and boasting 3 generous bedrooms, built/ins, 2nd toilet off the internal laundry, modern kitchen which opens onto the formal living room and dining area. The added bonus of a second separate tv/family room and a renovated bathroom make this property a must see.

The property also offers side access and a covered entertaining area perfect for the family BBQ's. Priced to sell and ready to move straight into makes this property one you should put on your list.



Charlotte Keene
02 9838 4888



Real Estate

5 Wellesley Crescent, Kings Park.

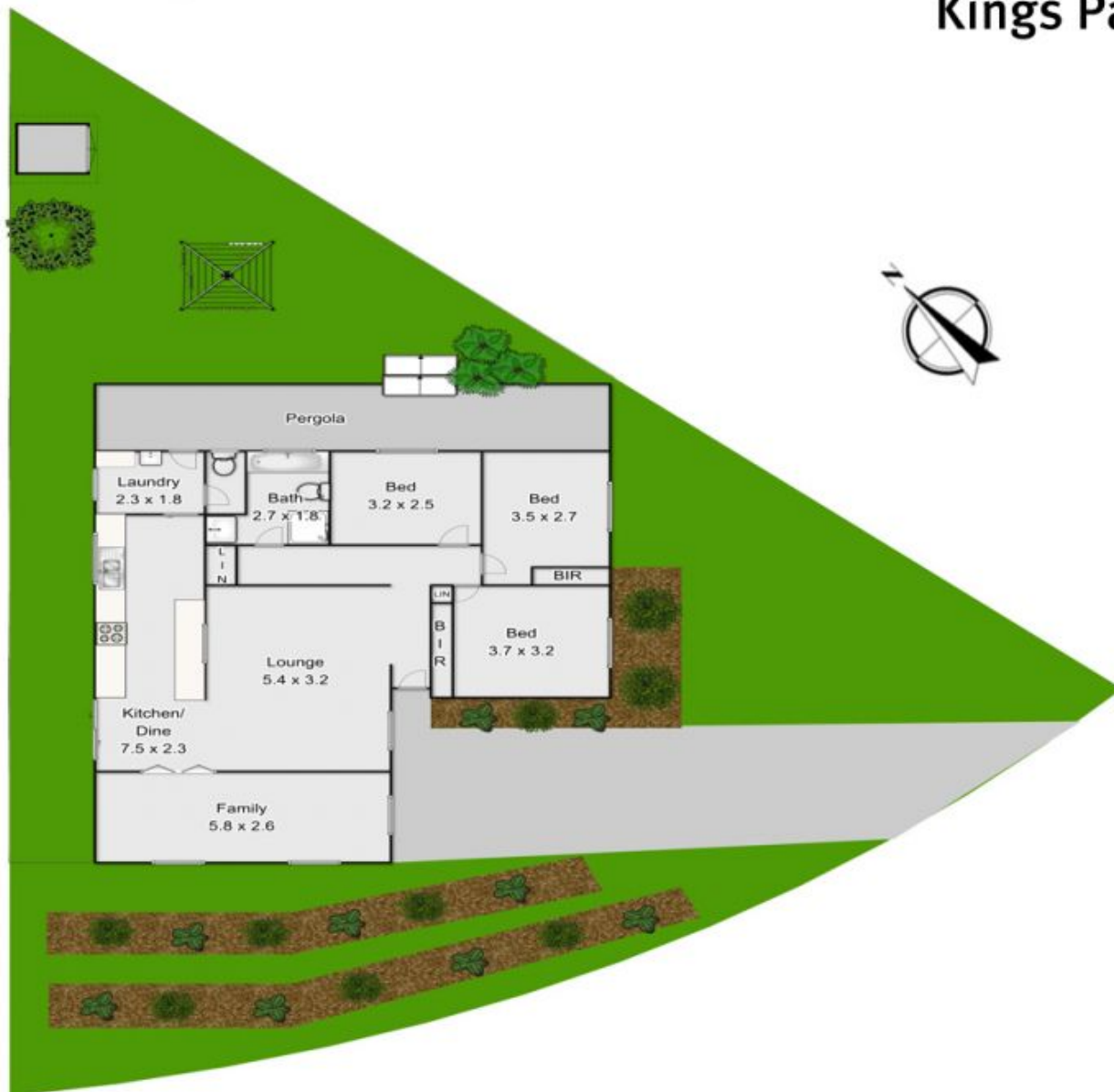

Plans are for presentation purposes only and are not part of any legal document or title. They should not be used as sole reference. Interested parties should make their own enquiries using other sources. Measurements are approximates.