



6 Faulkland Crescent Kings Park NSW

4  1  1 

This excellent family home has been lovingly cared for and presents in excellent condition. Situated high side of a quiet street with the convenience of being walking distance to buses, train station, schools, parks, reserves and a short drive to M2 & M7 motorways.

Featuring a large lounge/dining, timeless Tasmanian oak kitchen which boasts plenty of cupboards, bench space and storage, 4 bedrooms with master bed offering large built/ins, modern bathroom, separate toilet, ducted r/c air conditioning, roller shutters to all windows, generous lock/up garage with the added bonus of loads of under home storage.

The large block offers an excellent front and rear yard, side access and a covered entertaining area for your friends and family to enjoy. Make sure you add this superb family

Price : \$ 730,000
Land Size : 598 sqm
View : <https://www.elderskingslangley.com.au/sale/nsw/western-sydney/kings-park/residential/house/5866921>



Charlotte Keene
02 9838 4888

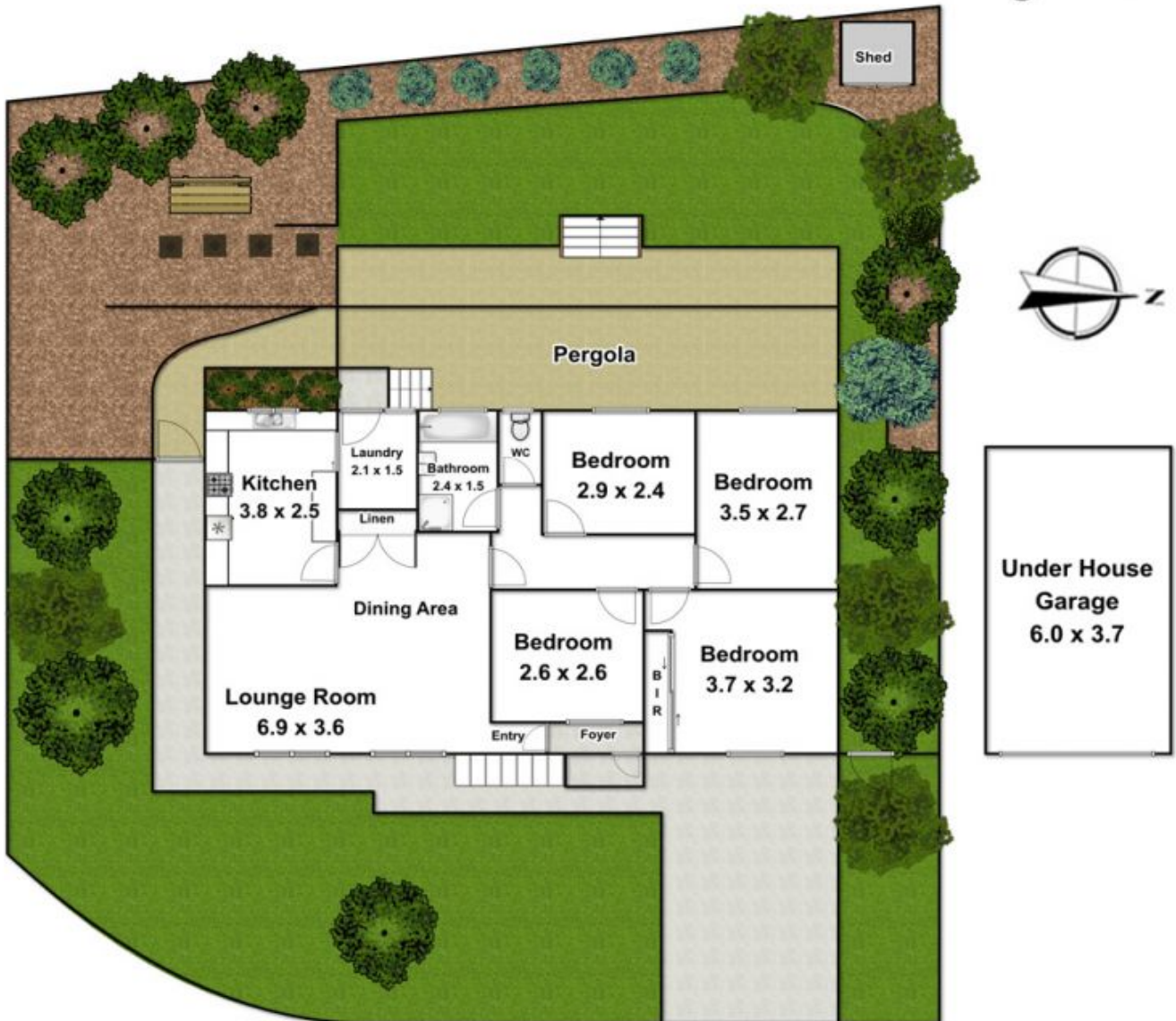

Plans are for presentation purposes only and are not part of any legal document or title. They should not be used as sole reference. Interested parties should make their own enquiries using other sources. Measurements are approximates.