



## 12 Jubilee Close Kings Langley NSW

4  2  2 

Here is your chance to acquire an almost new home in the popular suburb of Kings Langley. This quality home is situated in the areas most recent sub-division and also located within the sought-after Kings Langley Primary school catchment.

Positioned perfectly amongst other new and quality homes and adjacent beautiful parkland reserve. This single level home boasts all the inclusions you should need including, 4 generous bedrooms plus separate study area, formal lounge and dining, huge family area plus 2nd tv or rumpus room, master bedroom with walk/in robe and ensuite, modern gas kitchen with island bench, ducted r/c air conditioning, superb undercover entertaining area, low maintenance and manicured front and rear yards, double garage offering internal access and auto door.

**Price** : \$ 885,000  
**Land Size** : 450 sqm  
**View** : <https://www.elderskingslangley.com.au/sale/nsw/western-sydney/kings-langley/residential/house/5867129>



**Charlotte Cooke**  
**02 9838 4888**

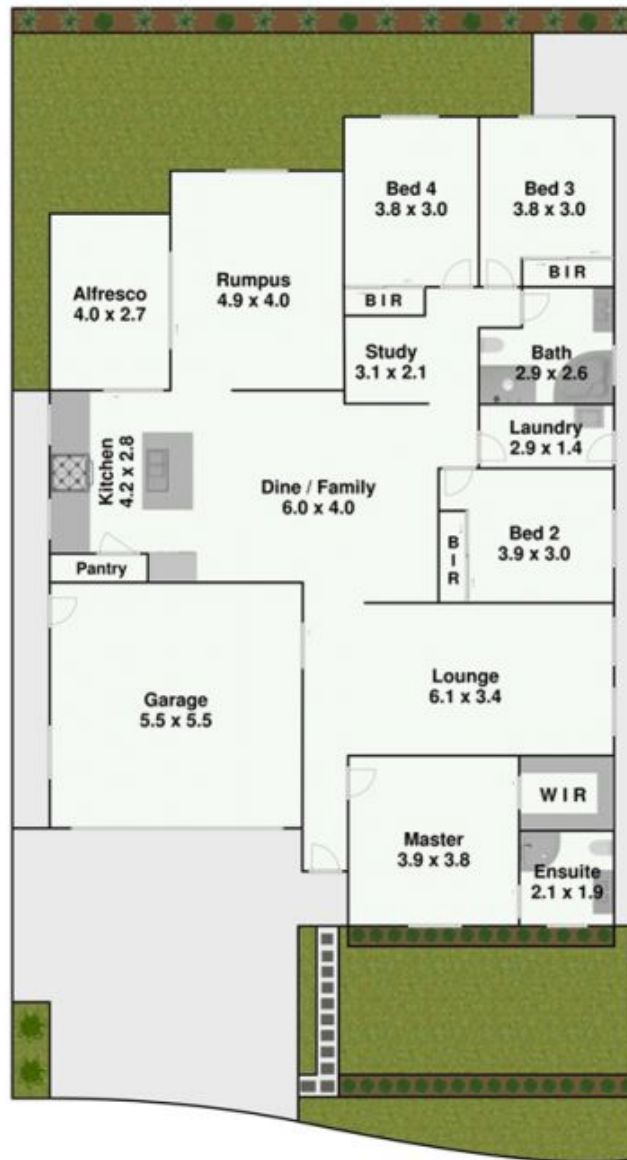

Plans are for presentation purposes only and are not part of any legal document or title. They should not be used as sole reference. Interested parties should make their own enquiries using other sources. Measurements are approximates.