





110 Donohue Street Kings Park NSW

4  1  3 

Shane Smith and Elders Real Estate proudly present 110 Donohue Street Kings Park. If you have been looking for a home that has had all the hard work done then look no further.

Sitting on a level 556m² block this 4-bedroom, 3 with built-ins, 1 bathroom home has been lovingly maintained and renovated by the current owners.

From the moment you enter the property it feels like home, with newly painted internals and beautiful floating hardwood flooring.

Featuring a huge newly renovated kitchen complete with quality inclusions, oversized soft closing drawers which flows into your open plan dining and lounge room areas.

Price : \$ 1,031,000
Land Size : 556 sqm
View : <https://www.elderskingslanglely.com.au/sale/nsw/western-sydney/kings-park/residential/house/7343280>

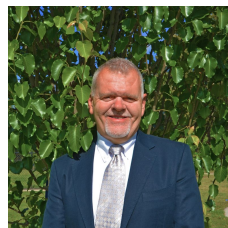

Shane Smith
0429 300 662



Charlotte Keene
02 9838 4888

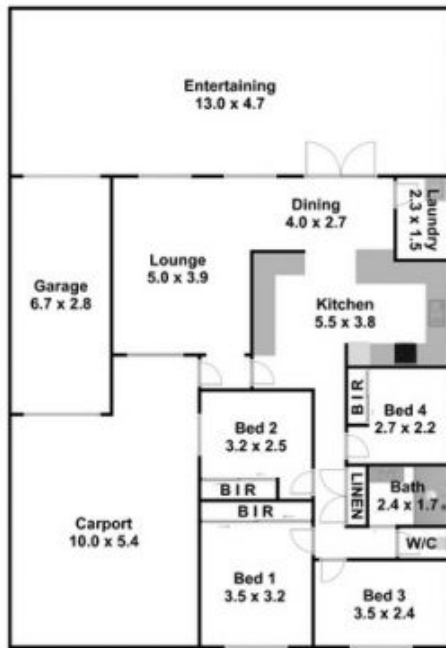

FLOORPLAN

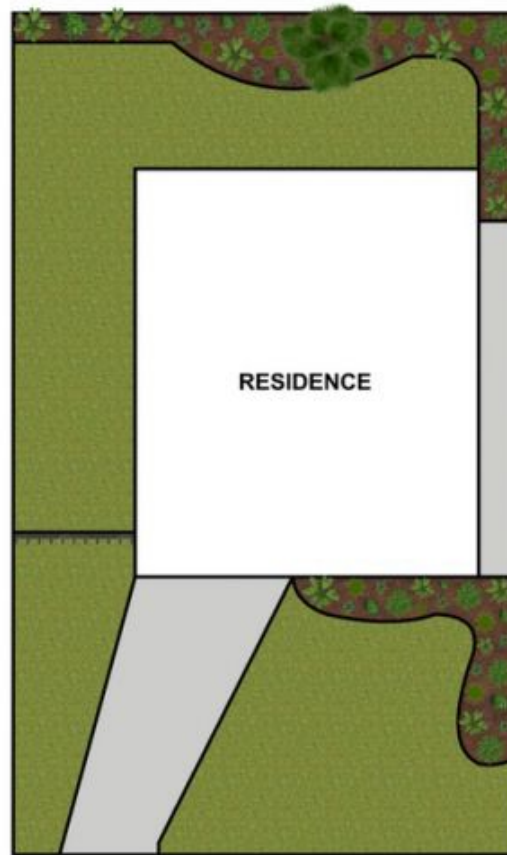

SITE PLAN