



50 Rosina Crescent Kings Langley NSW

4  2  2 

Shane Smith and Elders Kings Langley are proud to present 50 Rosina Crescent Kings Langley. If you are even contemplating purchasing in the area, then you must see what you could be missing out on.

Very rarely do properties come up in one of the most highly sought after locations in Kings Langley, Rosina Crescent. Sitting on 708m² of premium land, this single level 4 bedroom, 2 bathroom property, master with ensuite, stands out for all the right reasons.

As you pull into your driveway you know you're in for something special. With a smart lock system that knows when you're home the front door conveniently unlocks so you can simply walk straight in and relax, you can forget about the keys.

Price : \$ 1,491,000
Land Size : 708 sqm
View : <https://www.elderskingslangley.com.au/sale/nsw/western-sydney/kings-langley/residential/house/7372442>

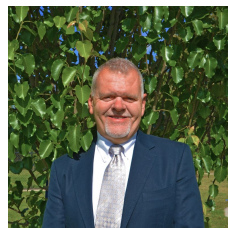

Shane Smith
0429 300 662



Charlotte Keene
02 9838 4888

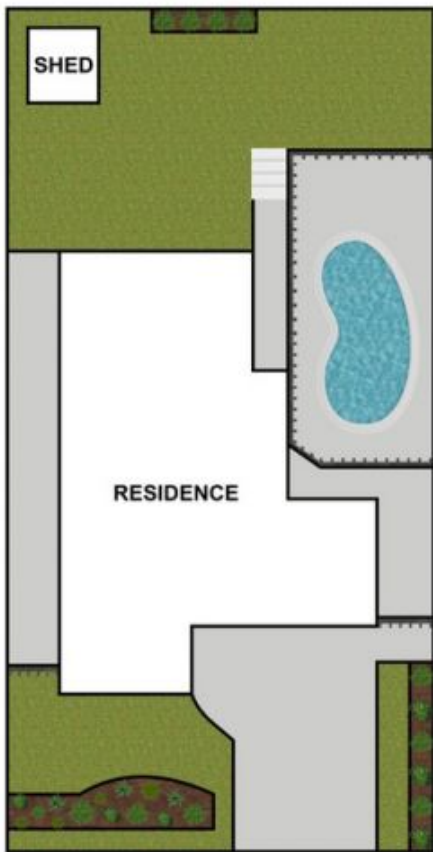

SITE PLAN

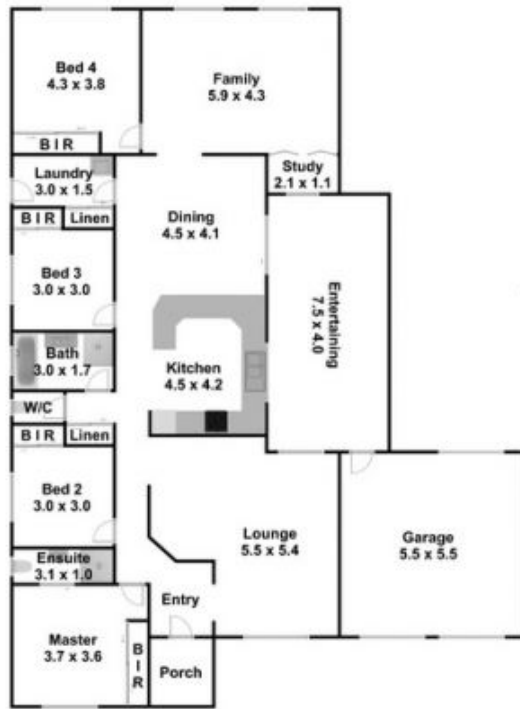

FLOORPLAN