





1/8 Carinya Road Girraween NSW

4  3  1 

Shane Smith and Elders Kings Langley are proud to present 1/8 Carinya Road Girraween to the market.

Conveniently situated in the family community of Girraween this designer townhouse has all that a family could wish for. Nestled on the high side of the street with endless views from the upstairs balconies this four-bedroom, 3 bathroom property is a must for first home buyers, astute investors or simply for those looking for the comfier things in life. Sitting proudly at the front of this secure complex your new family home is conveniently located within walking distance to all of the local amenities that this suburb has to offer.

- + Featuring 3 queen sized bedrooms with built-in robes, balconies off the two upstairs rooms
- + King-sized main bedroom with built-in robe, ensuite and private balcony

Price : \$ 930,000
Land Size : 210 sqm
View : <https://www.elderskingslangley.com.au/sale/nsw/parramatta/girraween/residential/townhouse/7656752>

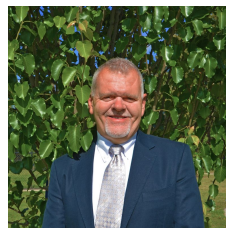

Shane Smith
0429 300 662



Charlotte Keene
02 9838 4888

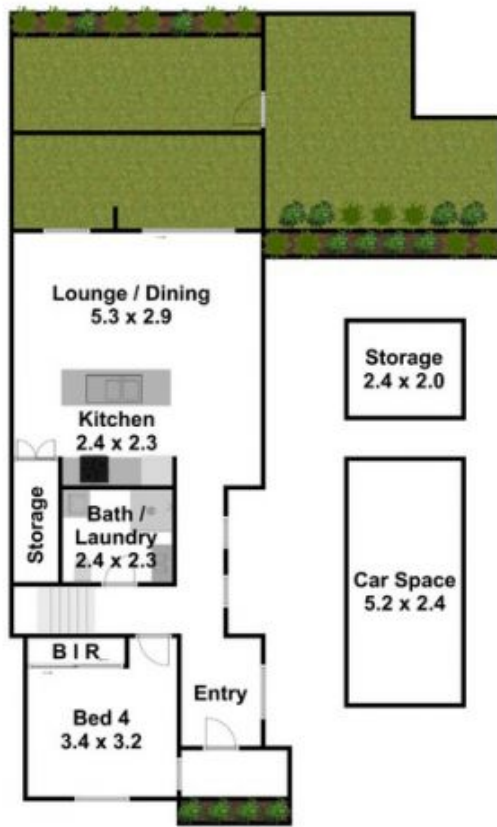

GROUND FLOOR

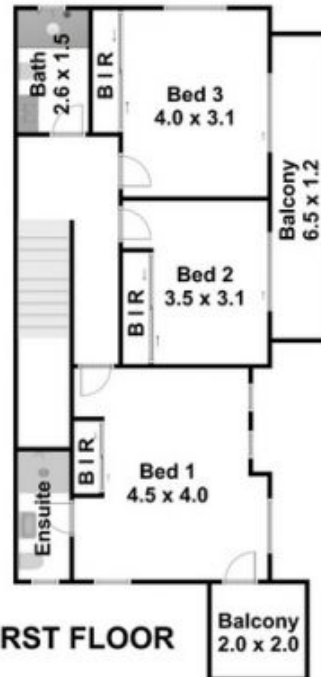

FIRST FLOOR