



11/81 Donohue Street Kings Park NSW

2  1  1 

Elders Kings Langley proudly presents to the market 11/81 Donohue Street, Kings Park to the market. This fantastic townhouse is nestled at the back of a well maintained complex and is a great opportunity for the first home buyers, the most astute of investors and downsizers who are looking for privacy and low maintenance living.

Price : \$ 640,000
Land Size : 238 sqm
View : <https://www.elderskingslangley.com.au/sale/nsw/western-sydney/kings-park/residential/townhouse/7685978>

- + 2 bedrooms both with built-in robes
- + Modern, well-maintained bathroom
- + Large kitchen complete with gas cooktop
- + Tiled open plan lounge and dining
- + Convenient powder room on the ground floor
- + Single car garage
- + Wrap around backyard for the most active of kids and pets
- + Strata approx. \$550 per quarter



Charlotte Keene
02 9838 4888



Shane Smith
0429 300 662

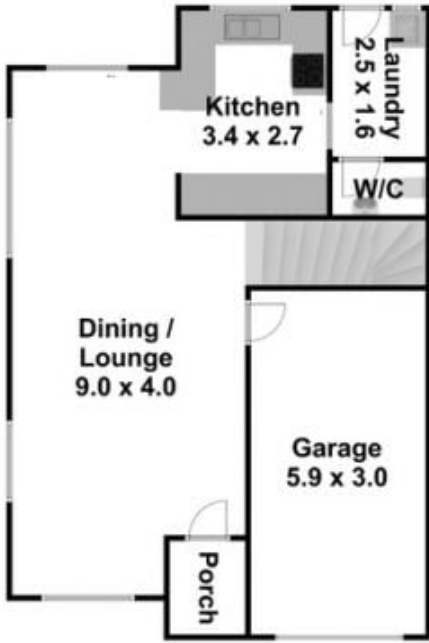

GROUND FLOOR

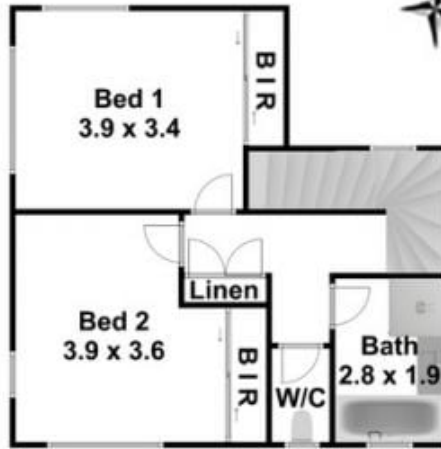

FIRST FLOOR

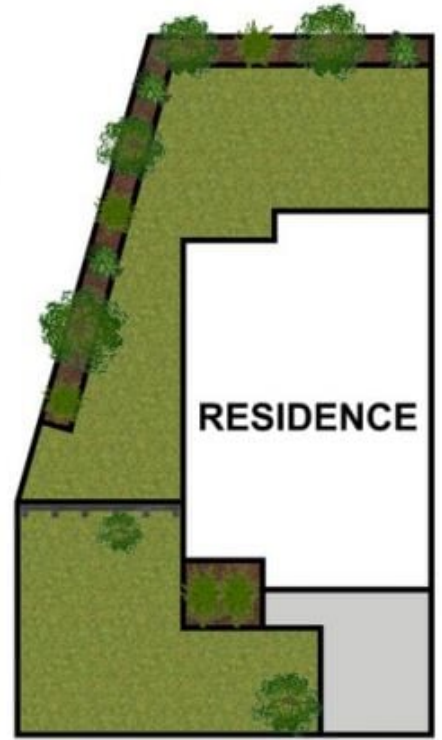

SITE PLAN